



Redhall Close, Hatfield, AL10 9EQ

Apartment | 1 Bedrooms

£1,100 Per Month

**LARKHAM
PIKE** &

www.larkhamandpike.co.uk



Energy Efficiency Rating		
	Current	Potential
<i>Very energy efficient - lower running costs</i>		
(92 plus) A		
(81-91) B		
(69-80) C		
(55-68) D	64	75
(39-54) E		
(21-38) F		
(1-20) G		
<i>Not energy efficient - higher running costs</i>		
England & Wales	EU Directive 2002/91/EC	

First Floor

Approx. 32.4 sq. metres (348.6 sq. feet)

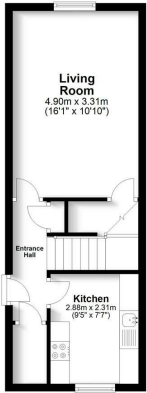

Second Floor

Approx. 22.9 sq. metres (246.8 sq. feet)

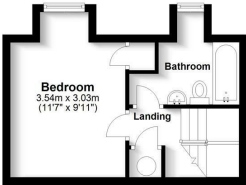

Total area: approx. 55.3 sq. metres (595.5 sq. feet)

For identification purposes only. Not to scale.
Plan produced using PlanUp.